

# Cube D400

## PRODUCT CARD

### Colour

White - Grey - Red

### DIMENSIONS

560cm x 580cm x 280cm

### WORKOUT SPACE

66m<sup>2</sup> ( 18 users )

### STATION DESCRIPTIONS

1. REBOUNDER - Ball Reactor, Wall Ball, 4x Shelves Storage, 2x Anchoring Points
2. CYCLE - Hand Cycle, 1 x Anchoring Point,
3. BENCH - 2x posts with bar attachment system, Multiposition Bench
4. RINGS - Gymnastic Rings, Protruding Ladder, Abdominal Bench, 2x Anchoring Points
5. CLIMBING BOARD - Climbing Stones, Pegs Road, 2x Torso
6. CALISTHENICS - Protruding Ladder, 2x Anchoring Points, Boxing Bag
7. LADDER - Vertical Ladder
8. PULL UP - Pull Up Handless, 1x Anchoring Point
9. STRETCH - Slanted Ladder with 2x Anchoring Points.
10. THRONE - Abdominal Throne
11. JUMPING - Jump Platform

### INSIDE

12. Monkey Bar – Horizontal Ladder
13. Sliding Pull - 4x Slanted Pull Up Handless
14. Suspension inside station - Grip Balls
15. Suspension inside station - Abdominal Straps
16. Wave Monkey Bar – Horizontal Wave Ladder

### WARRANTY

10 years in structure and welding.  
5 years against manufacturing defects affecting the structure.  
6 months for upholstery.  
90 days in other parts not listed in this warranty.



# Cube D400

## PRODUCT CARD

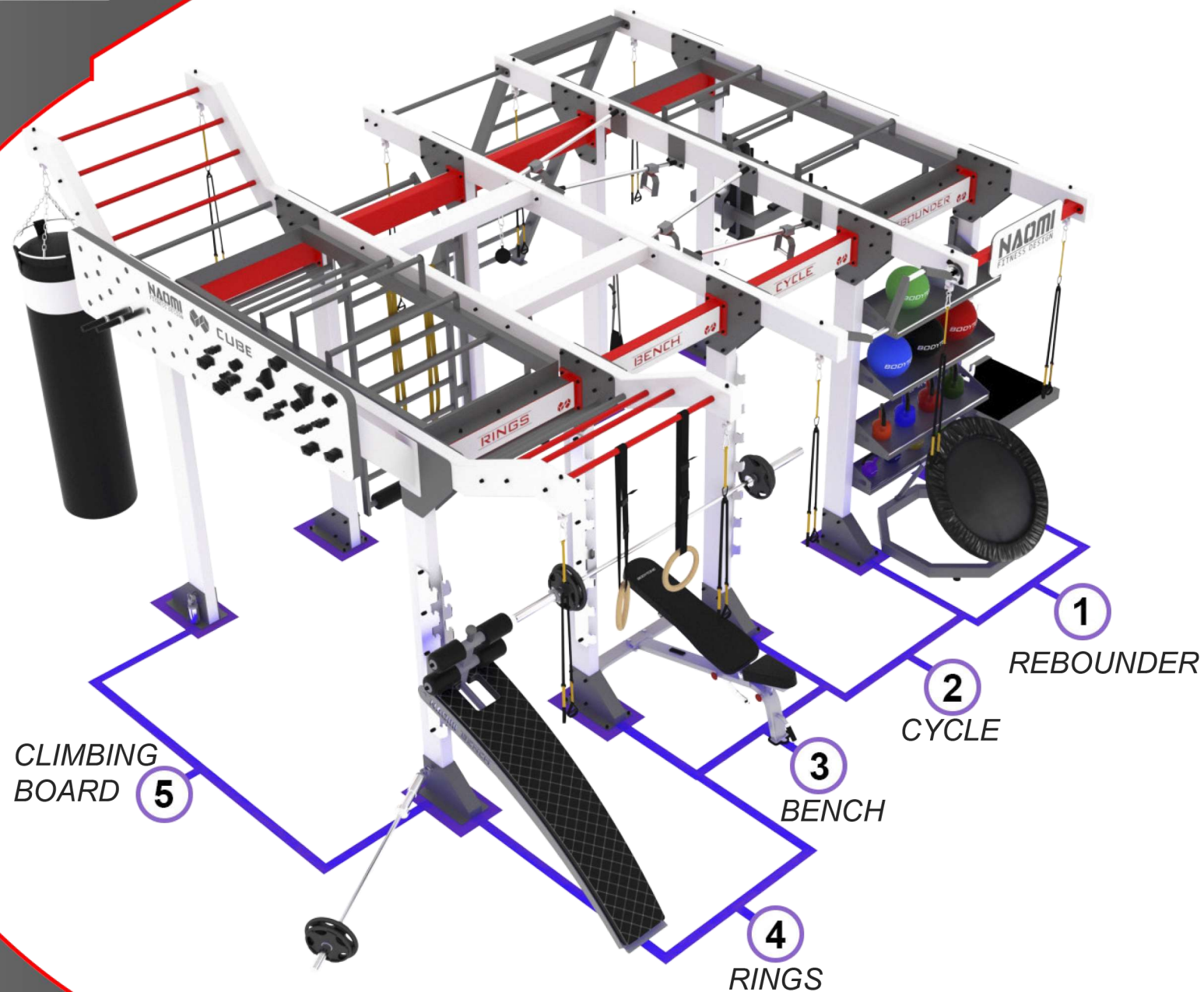

# Cube D400

## PRODUCT CARD

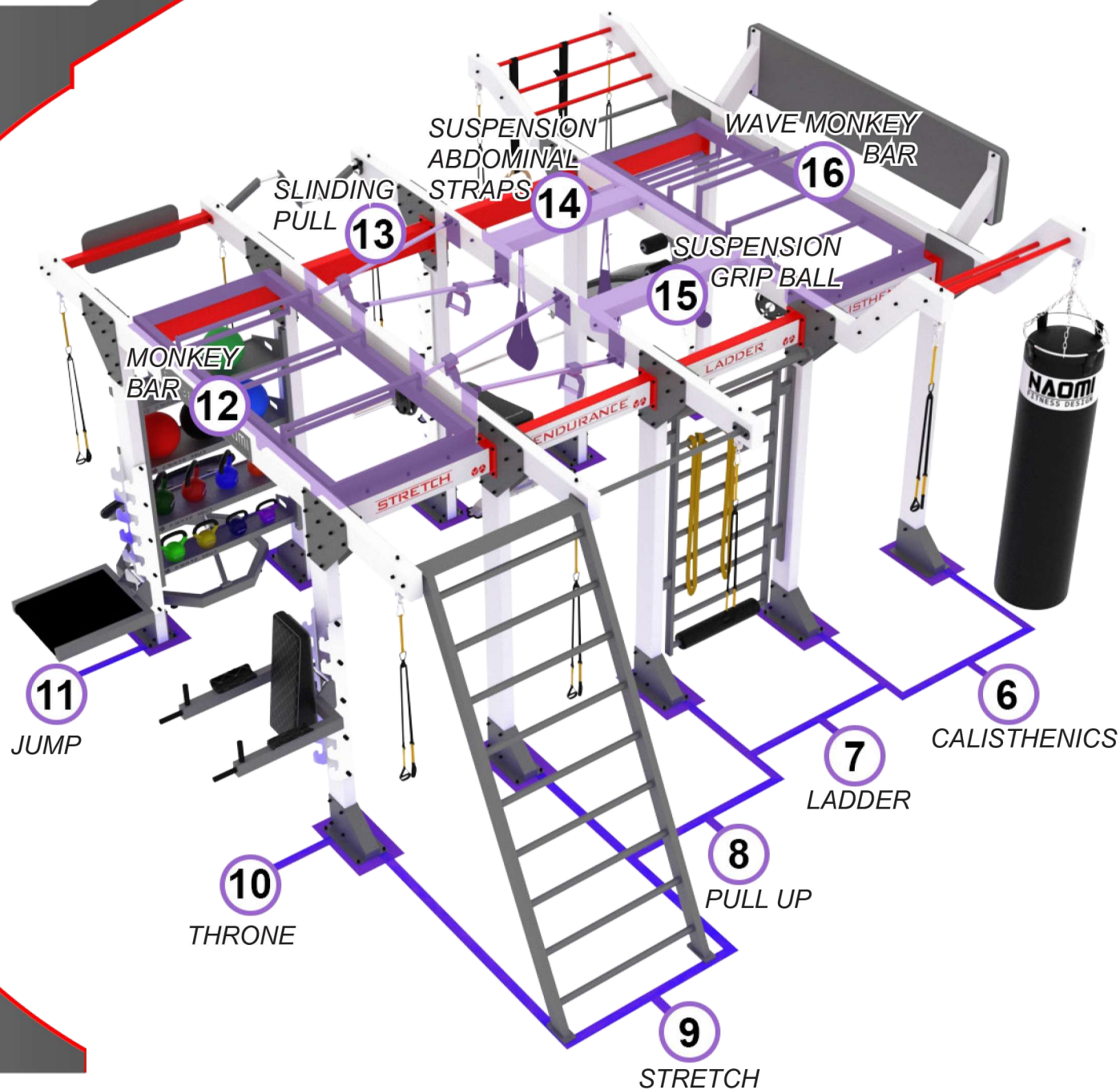



# Cube D400

## DIMENSIONS

## PRODUCT CARD

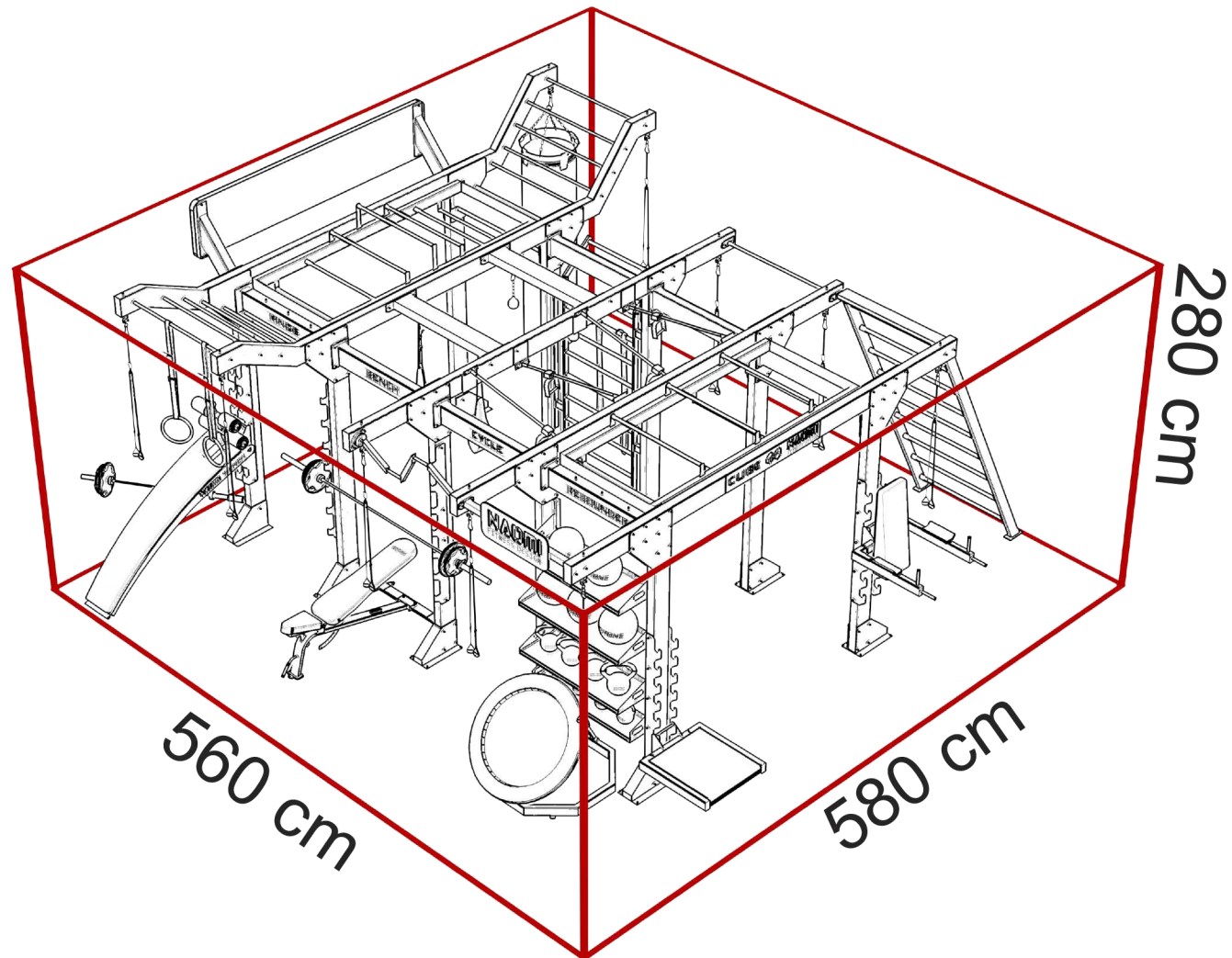

# Cube D400

**WORKOUT SPACE**  
**(66m<sup>2</sup>)**

**PRODUCT CARD**

750 cm

880 cm

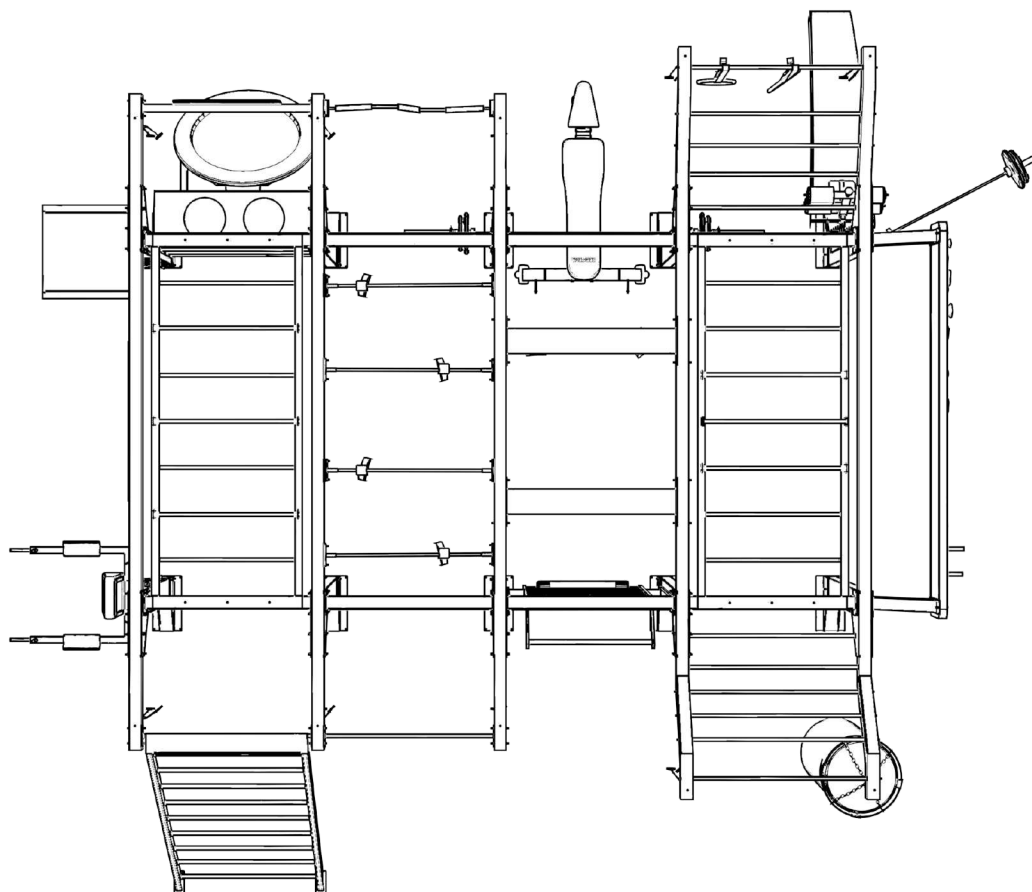

# Cube D400

## PRODUCT CARD

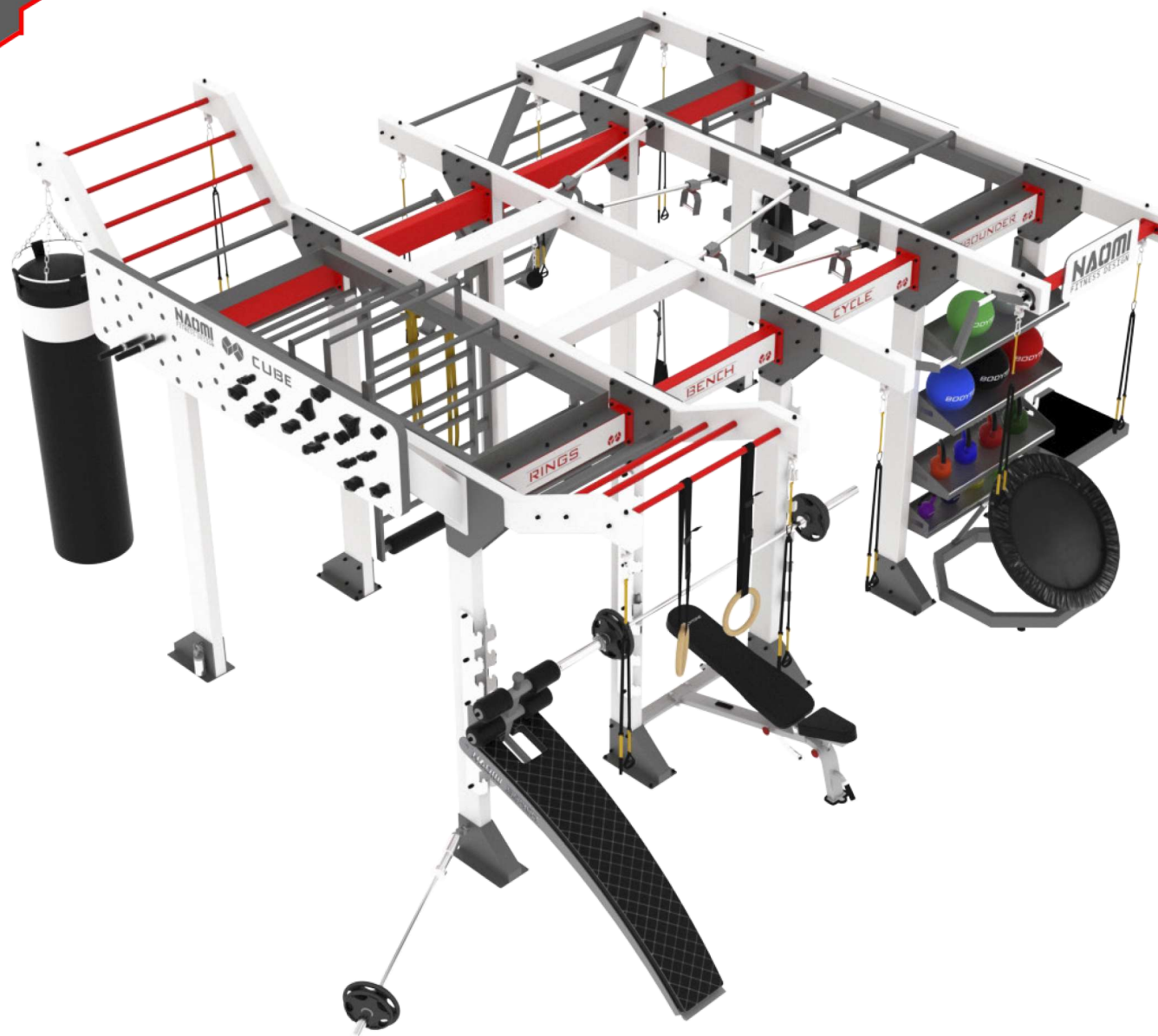

**NAOMI**  
FITNESS DESIGN

# Cube D400

## PRODUCT CARD



**NAOMI**  
FITNESS DESIGN



# Cube D400

## PRODUCT CARD

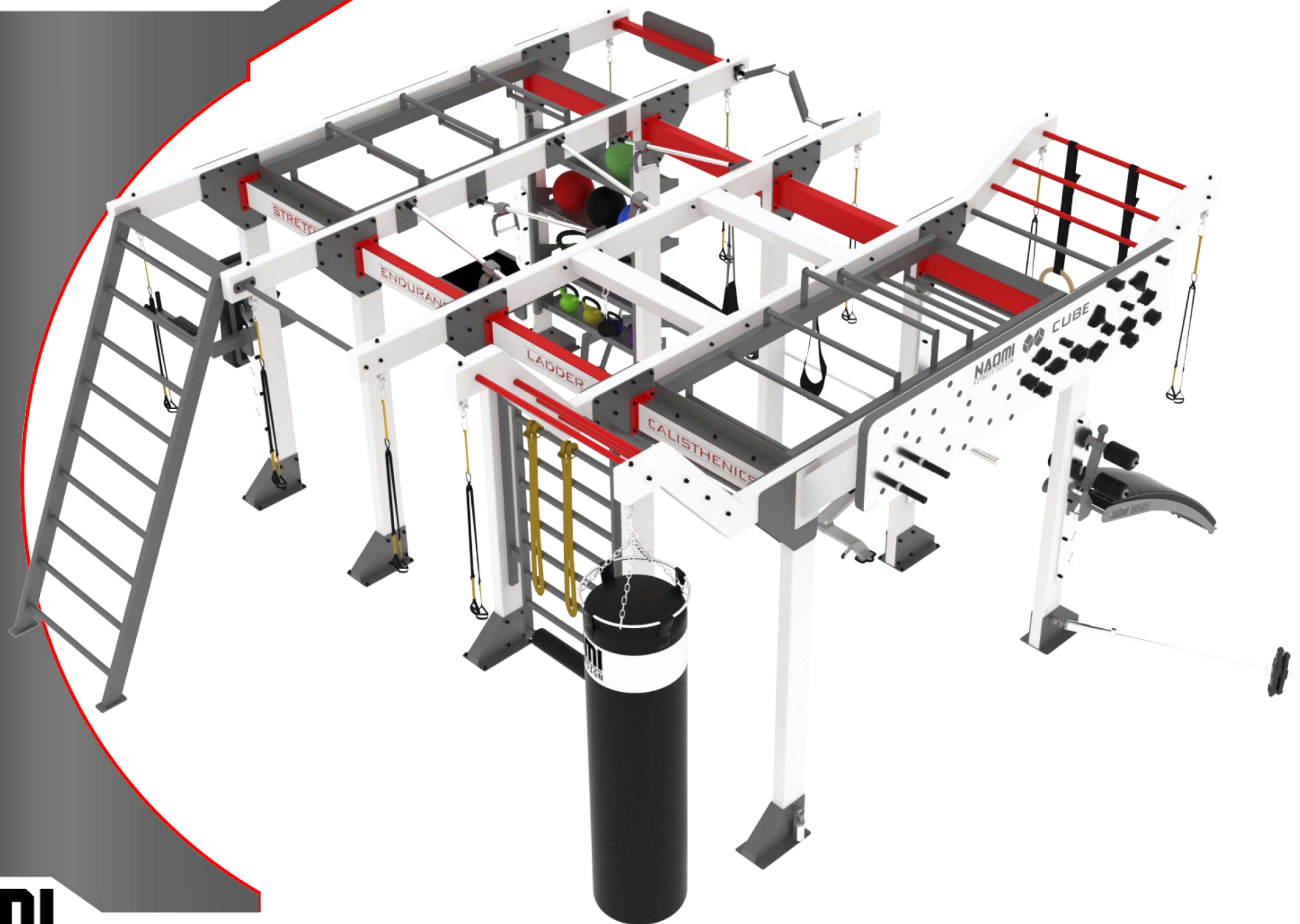



# Cube D400

## PRODUCT CARD



**NAOMI**  
FITNESS DESIGN